



Villa 51 On Fuchsia Lane

Set on Fuchsia Lane this two bedroom Palmer style villa offers a popular layout. The heart of this home is the living area which leads out onto the covered terrace, great for entertaining. The modern kitchen features all new appliances and ample storage. The master bedroom has two wardrobes, en-suite bathroom and there is an additional guest toilet. Internal garaging and an outside washing line completes this very special home.

- Two double bedrooms
- Fully refurbished
- New appliances
- Heat pump
- North facing lounge
- Internal garage
- Landscaped gardens
- En-suite & additional guest toilet

\$895,000

Purchase now under Right to Occupy



**Contact Michelle — Sales & Marketing Manager
for more information on**

0800 102 662
michelle.wainhouse@fairviewvillage.co.nz
21 Fairview Avenue, Albany
www.fairviewvillage.co.nz

Palmer Villa

Now this feels like home

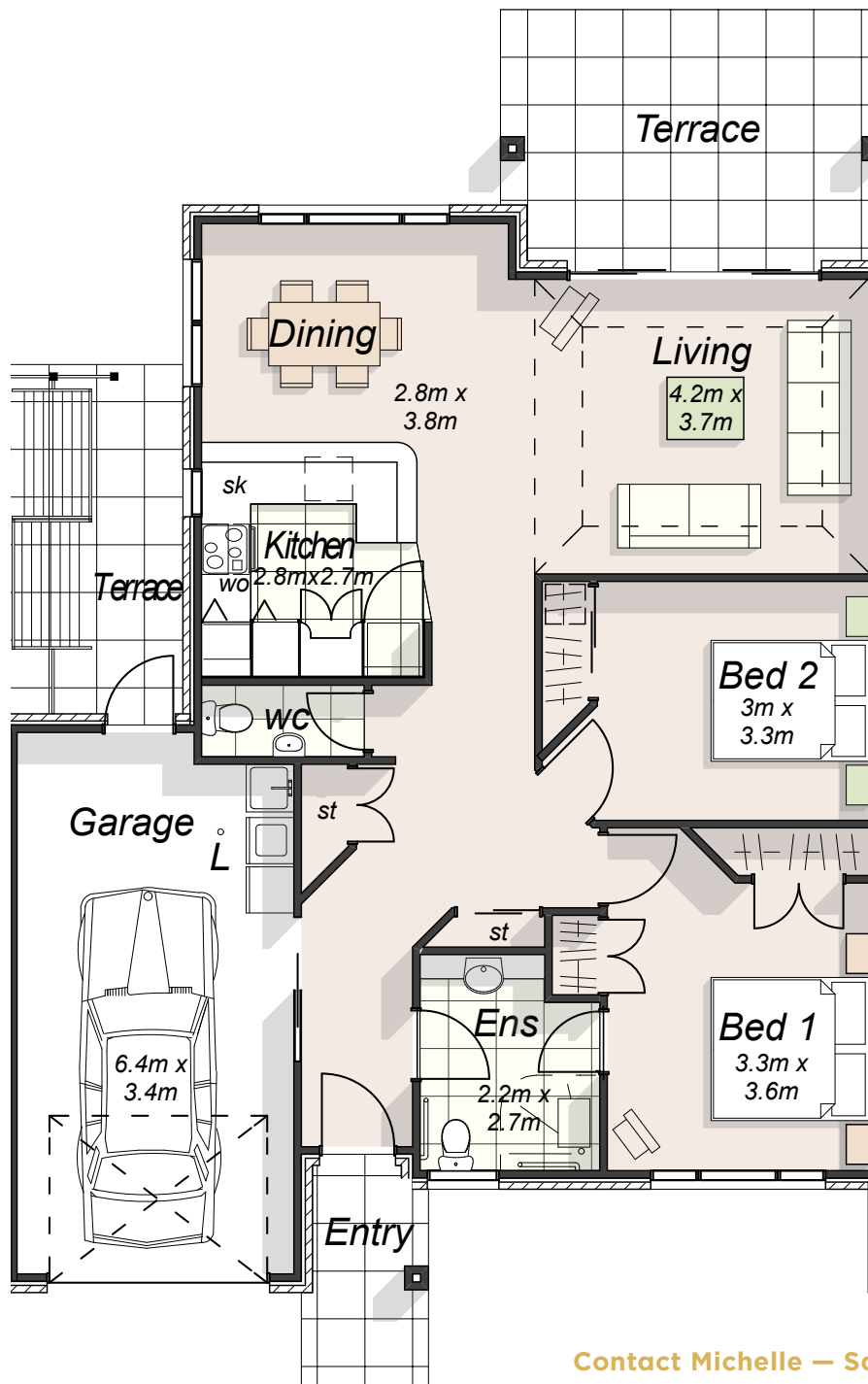

Contact Michelle — Sales & Marketing Manager
for more information on

0800 102 662
michelle.wainhouse@fairviewvillage.co.nz
21 Fairview Avenue, Albany
www.fairviewvillage.co.nz

Terrace Area = 24m²
Internal Area = 114m²
Total Area = 138m²

Plans and photographs are representational only

By Premier Lifestyle Villages

Premier Lifestyle Villages Group includes Fairview Lifestyle Village, Fairview Care and Settlers Lifestyle Village

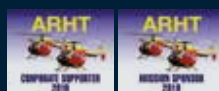

Corporate and Mission
sponsor for Westpac
Rescue

fairview
LIFESTYLE VILLAGE